



ACS-Report-NOTE®



DOWNLOAD & INSTALLATION

INS-Player Android app link : www.ineo-sense.com/downloads/INS-Player_v1.apk

You will need to allow installation of apps from unknown sources in security settings of your mobile.

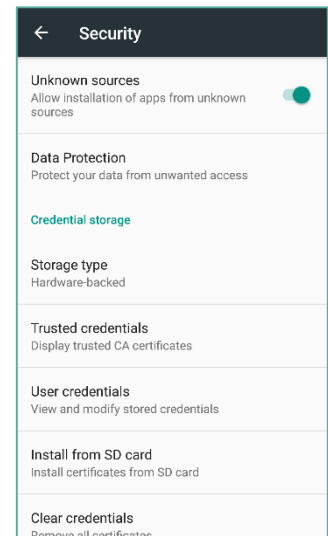
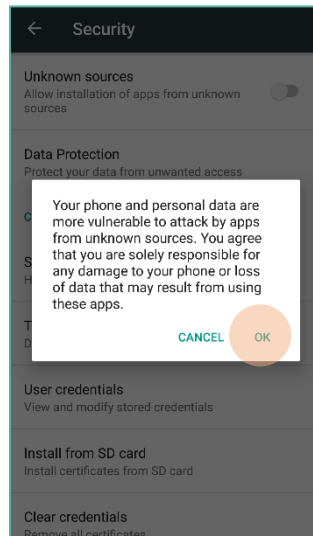
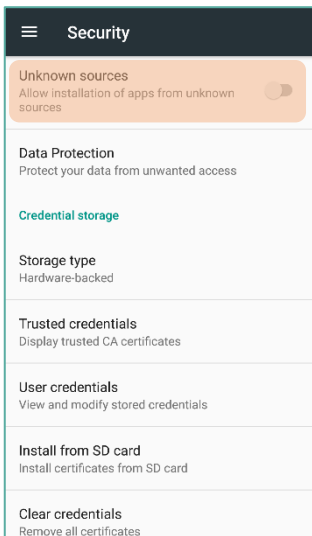

INS-BLUEREAD PAIRING

First pair your INS-Bluread with your mobile and the app. To do so:

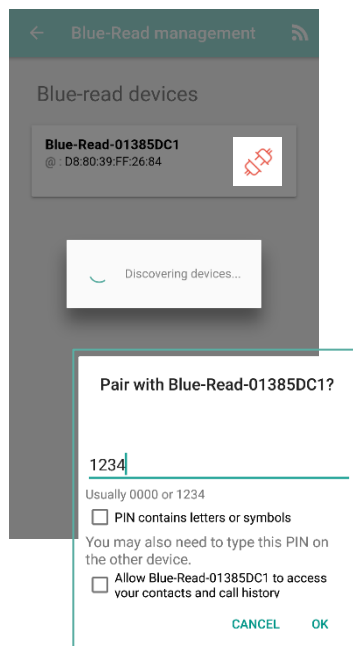
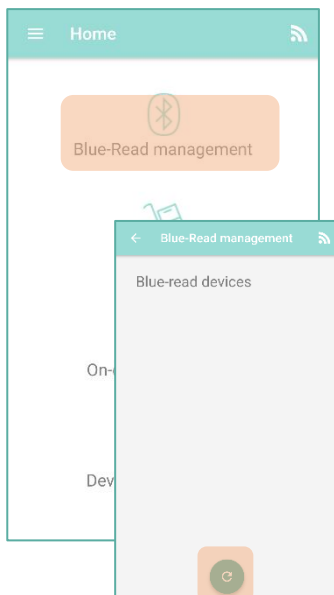

1. Refresh devices list to find your INS-Bluread
2. Click on the connect button of the desired device
3. When asked, enter the Bluetooth pairing code: **1234**

CHOOSE PROFILE AND SETUP INS-BLUEREAD

1. Once connected to the INS-Bluread, you can choose the profile that matches the device you want to setup. You can choose a **basic profile**, with the usual features and commands or an **expert profile**, to go deeper in the device setup.

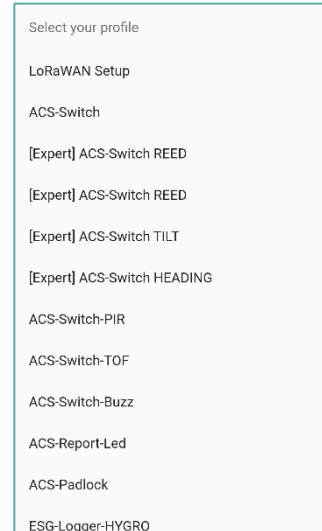

2. Right after choosing the profile of your device, you need to set up the *INS-BlueRead* in the right communication mode.

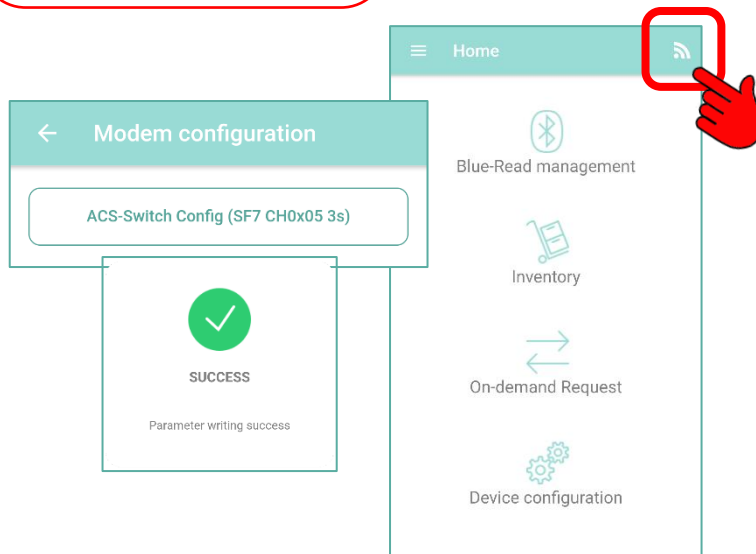

ACTIONS

You will then be able to go through the list of your devices, request their states/ settings and modify them.

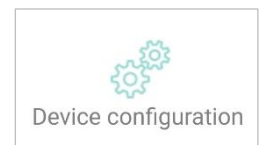

ON-DEMAND REQUEST MENU

After the installation of the INS-Mobile App and when the connection between the sensor and the BlueRead is ready to work, you are able to exchange data with the sensor and configure it.



This menu allows you to read the following information about the sensor :

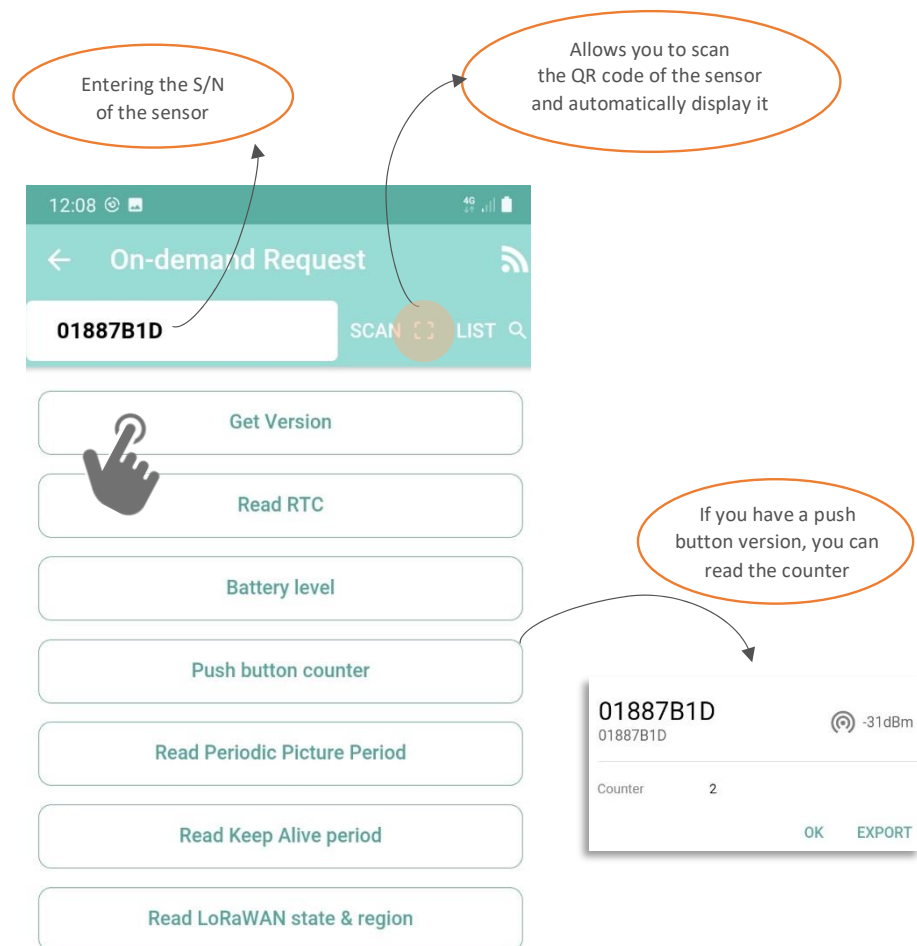

Entering the S/N of the sensor

Allows you to scan the QR code of the sensor and automatically display it

12:08 4G

← On-demand Request

01887B1D SCAN LIST

- Get Version
- Read RTC
- Battery level
- Push button counter
- Read Periodic Picture Period
- Read Keep Alive period
- Read LoRaWAN state & region

If you have a push button version, you can read the counter

01887B1D -31dBm

01887B1D

Counter 2

OK EXPORT

DEVICE CONFIGURATION MENU

This menu allows you to send information to the sensor to configure it. For the ACS-Report-NOTE, you can set up a lot of parameters.

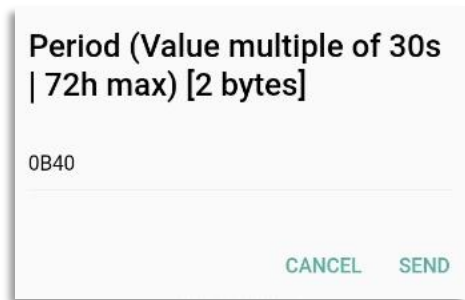
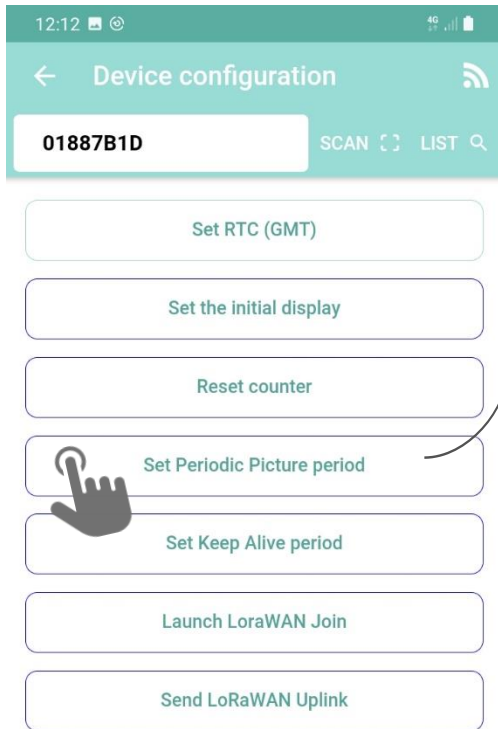

In this example, we have chosen a periodicity every 24 hours :

$24 \times 3600 = 86400s$
but the value has to be a multiple of 30s

so $86400 / 30 = 2880$
or **0B40** once converted in hexadecimal.

APPLICATION UPDATES AND SPECIAL MODE

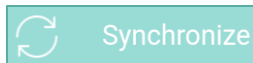
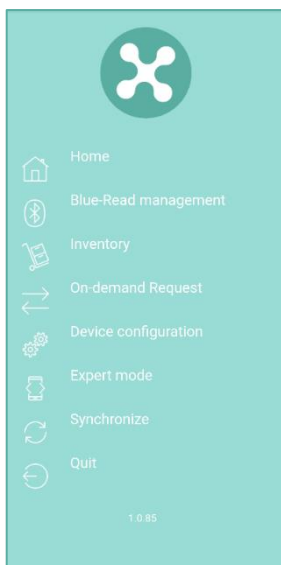

When it is necessary and requested by INEO-SENSE support, you can update and synchronize your mobile app to discover new features and new buttons to achieve your settings.

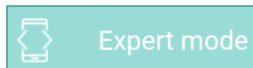

An **EXPERT** mode is also available to compute your own requests and commands.

→ *Refer to Technical Documentation and INEO-SENSE support*

