

## ACS-Report-LED<sup>®</sup>



## DEVICE INSTALLATION

### POSITIONING

The ACS-Report-LED Switch can be installed either vertically (floor / ceiling) or horizontally.

### MOUNTING

The device can be mounted either by screw or glued. Optional personalized support can be provided if requested.

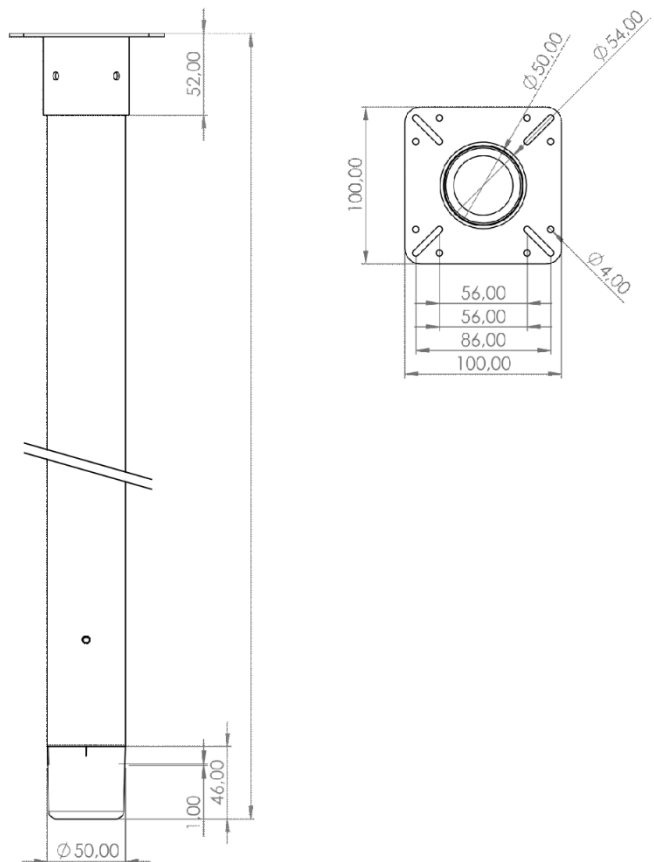
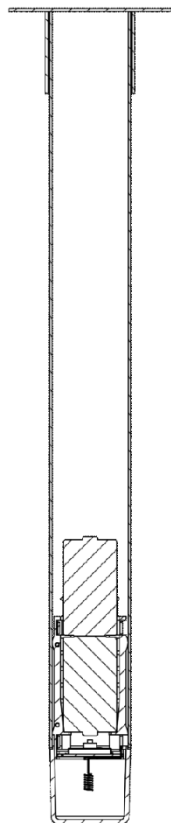

## START-UP

Please make sure the LoRaWAN settings of your ACS-Report-LED (DevEUI, AppEUI, AppKey) are filled in with your preferred LoRaWAN operator.



- 1 Put a magnet on the QRCode label of the ACS-Report-LED
- 2 The LED of the ACS-Report-LED starts blinking red slowly for 3s and then blinks quickly
- 3 Wait until the LED starts blinking slowly again to remove the magnet. The ACS-Report-LED starts its installation and the LED blinks Green and Red alternatively



If joined successfully, the LED will blink Green quickly during 5s, otherwise it will blink Red.



In case of success, the ACS-Report-LED will initialize and the LED will blink Orange for 5 seconds.



Once installed on your LoRaWAN network, the device will push its payload (by default every 15mn).

**Please refer to the technical documentation for the device settings and commands.**

## INS-PLAYER APPLICATION/ INS-BLUERead MODE

Android mobile app: [www.ineo-sense.com/downloads/INS-Player\\_v1.apk](http://www.ineo-sense.com/downloads/INS-Player_v1.apk)

Our application and its ACS-Report-LED profile allows the configuration and the product settings through our Bluetooth/LoRa handheld modem.



**Please refer to the documentation of the INS-Player mobile application**